

BTH-500R ESChat manual

iOS Setting

1. Go to "Setting" -> "Bluetooth", turn on iPhone's Bluetooth and BTH-500R you will find "Blu-PTT" and "BTH-PTT" or "BTHR-PTT". Tap both to connect.

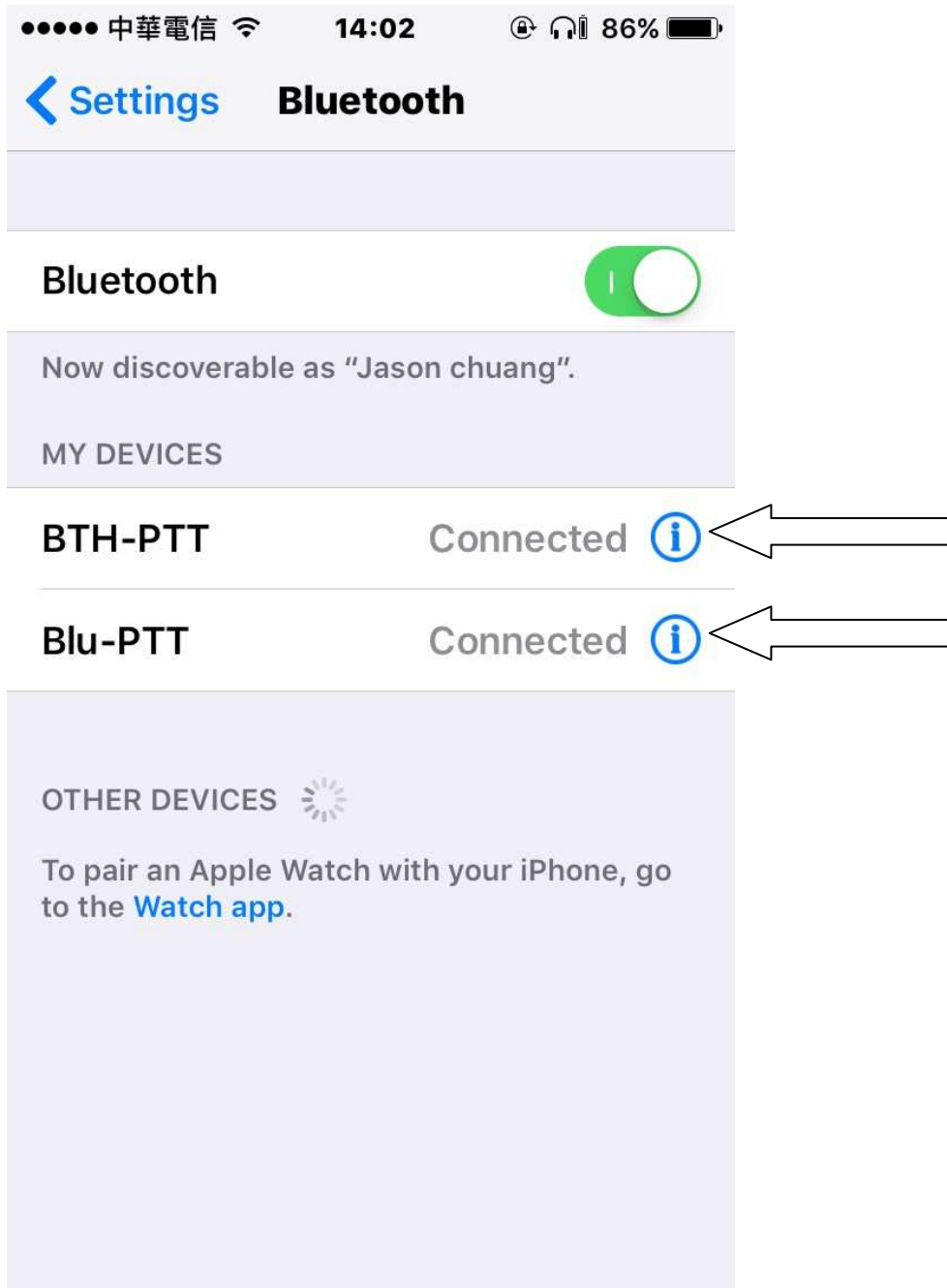

2.Go to “More” on the right top.

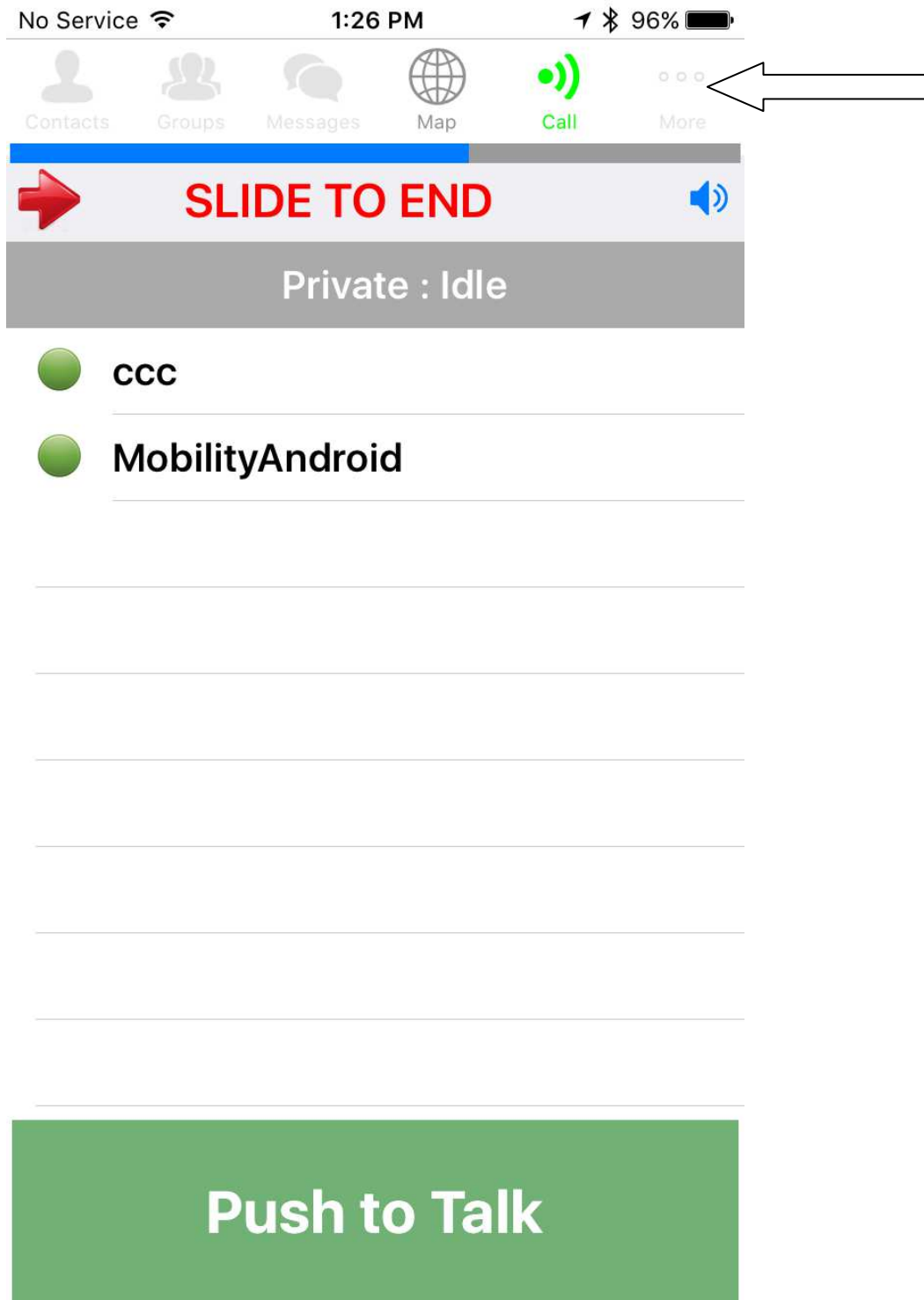

3.go Settings

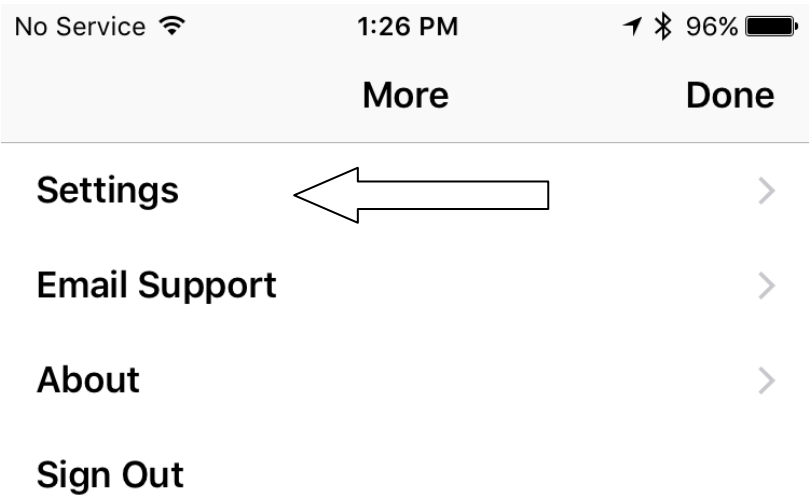

4.go Headset Sound Profile

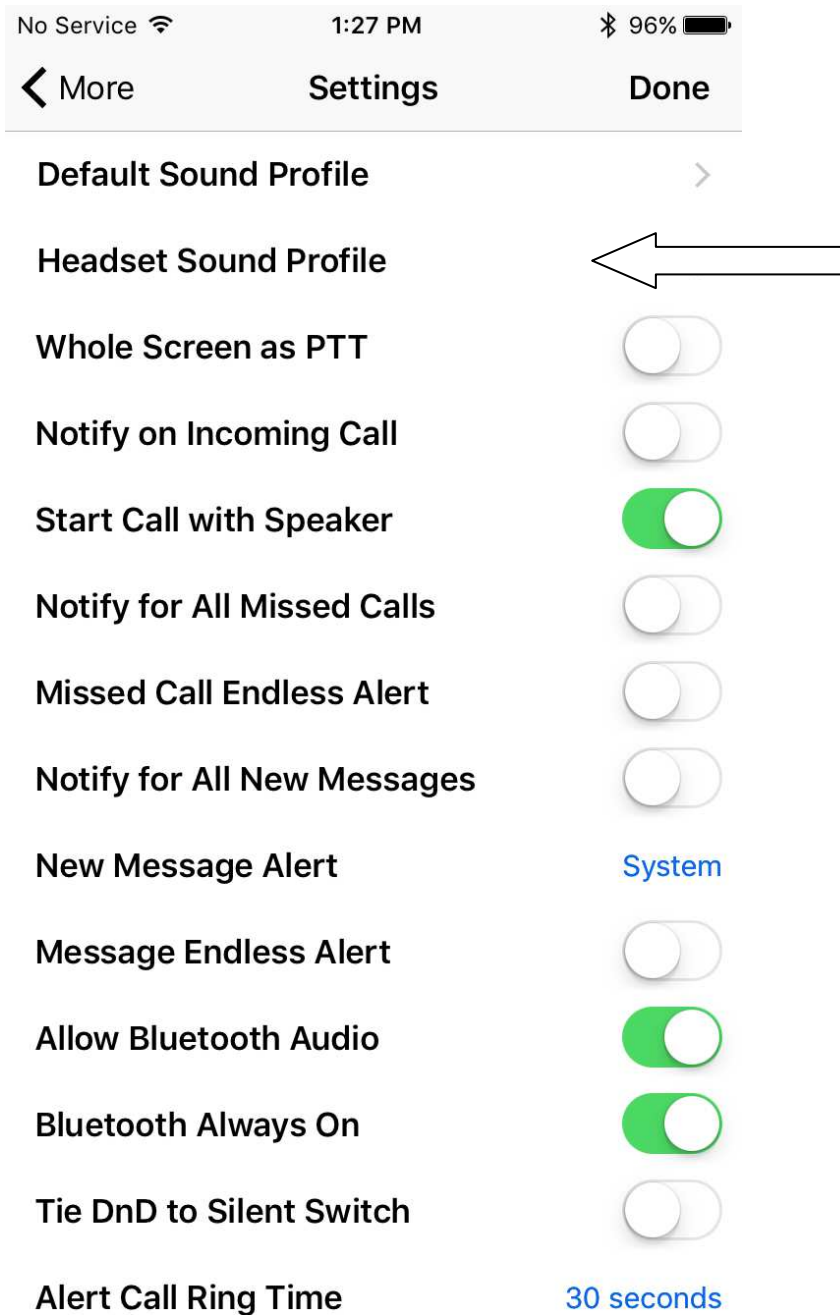

5.Go Headset Type

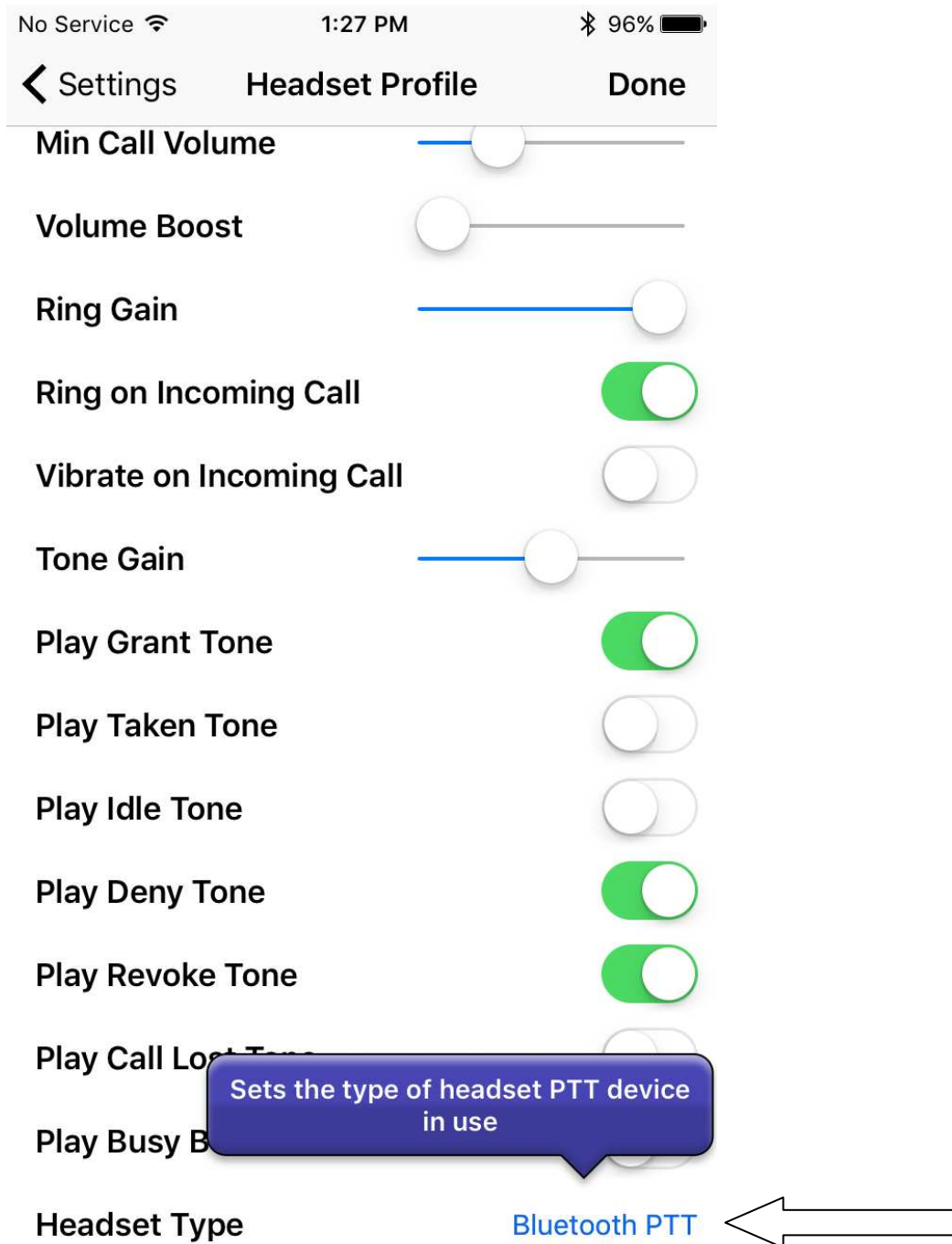

6. Choose Bluetooth PTT, then it's ready to go

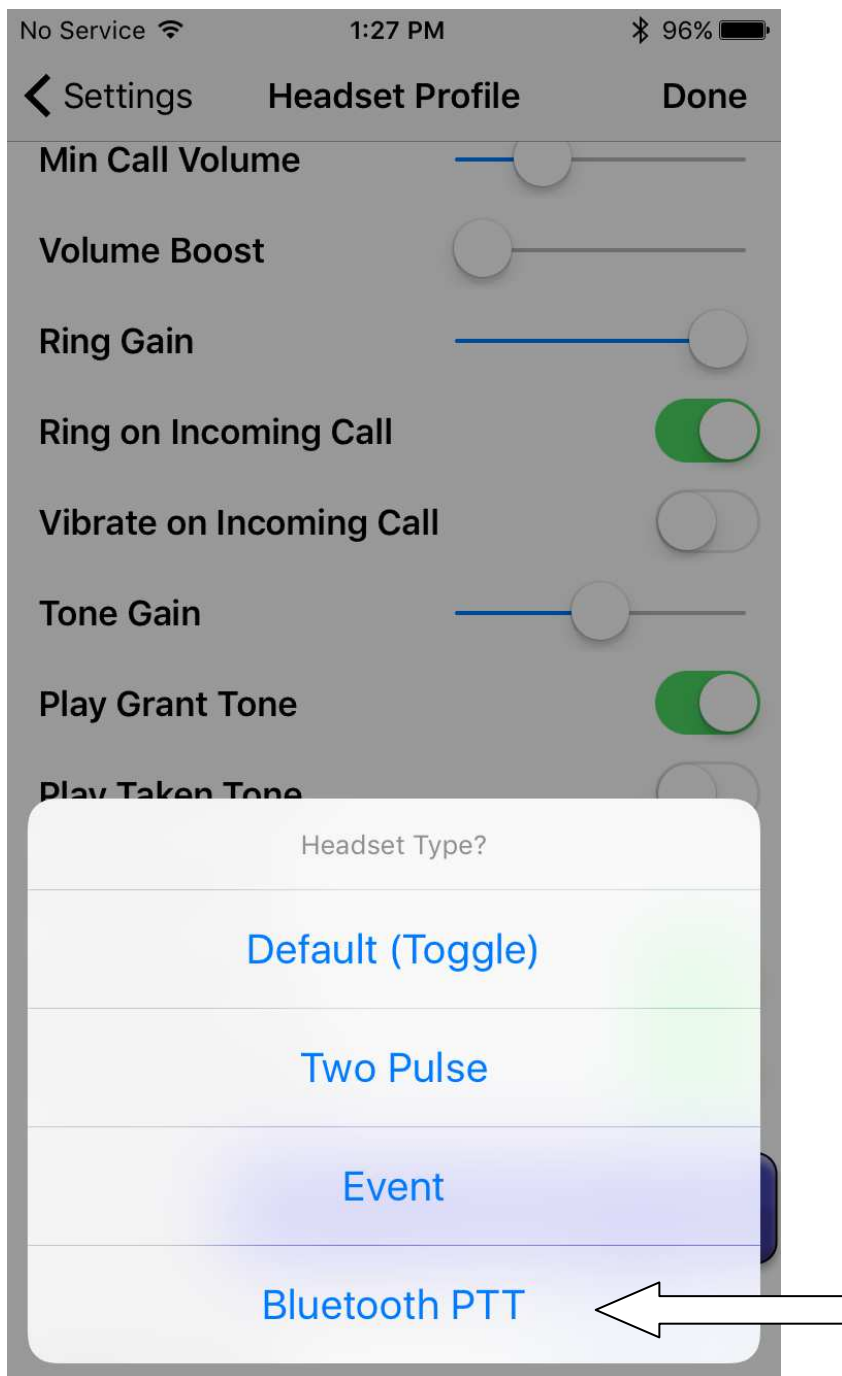

Andorid Setting

1. Go to "Setting" -> "Bluetooth", turn on Mobile phone's Bluetooth and BTH-500R you will find "Blu-PTT" and "BTH-PTT" or "BTHR-PTT". Tap both to connect.

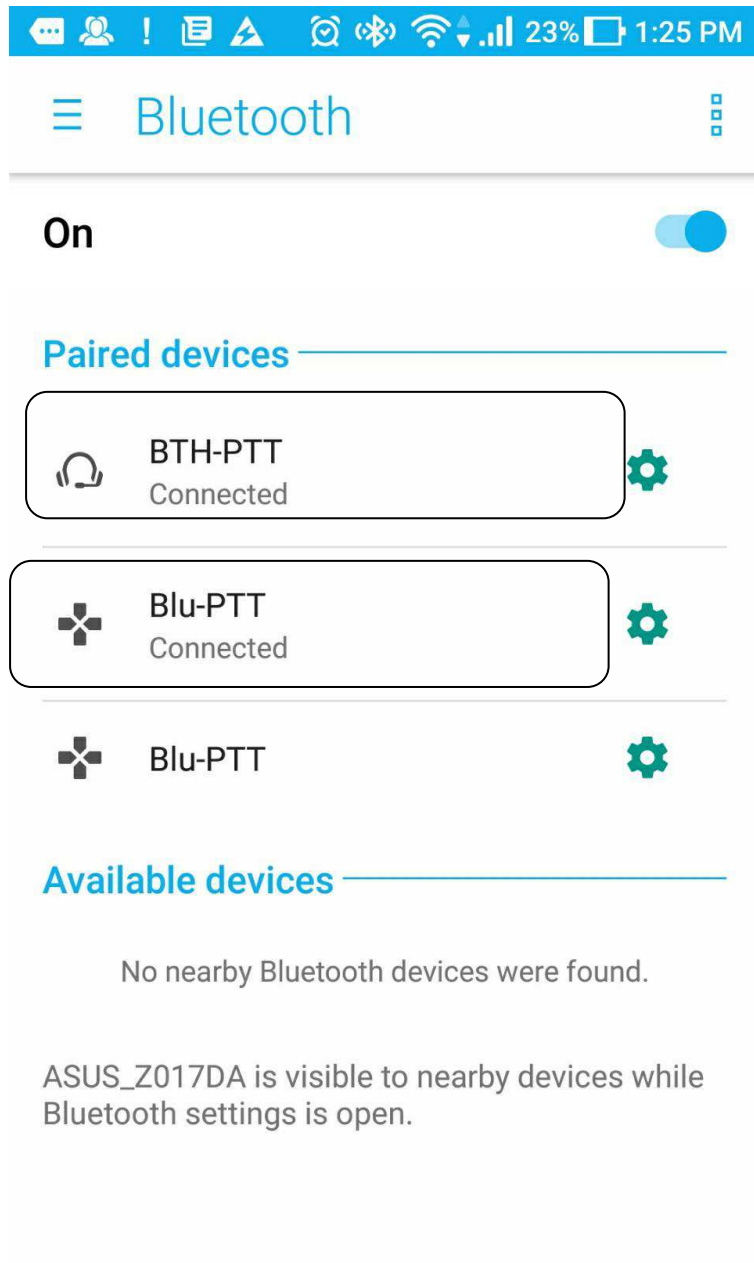

2. After connection is established, execute ESChat tap the menu on the top right and select "Setting".

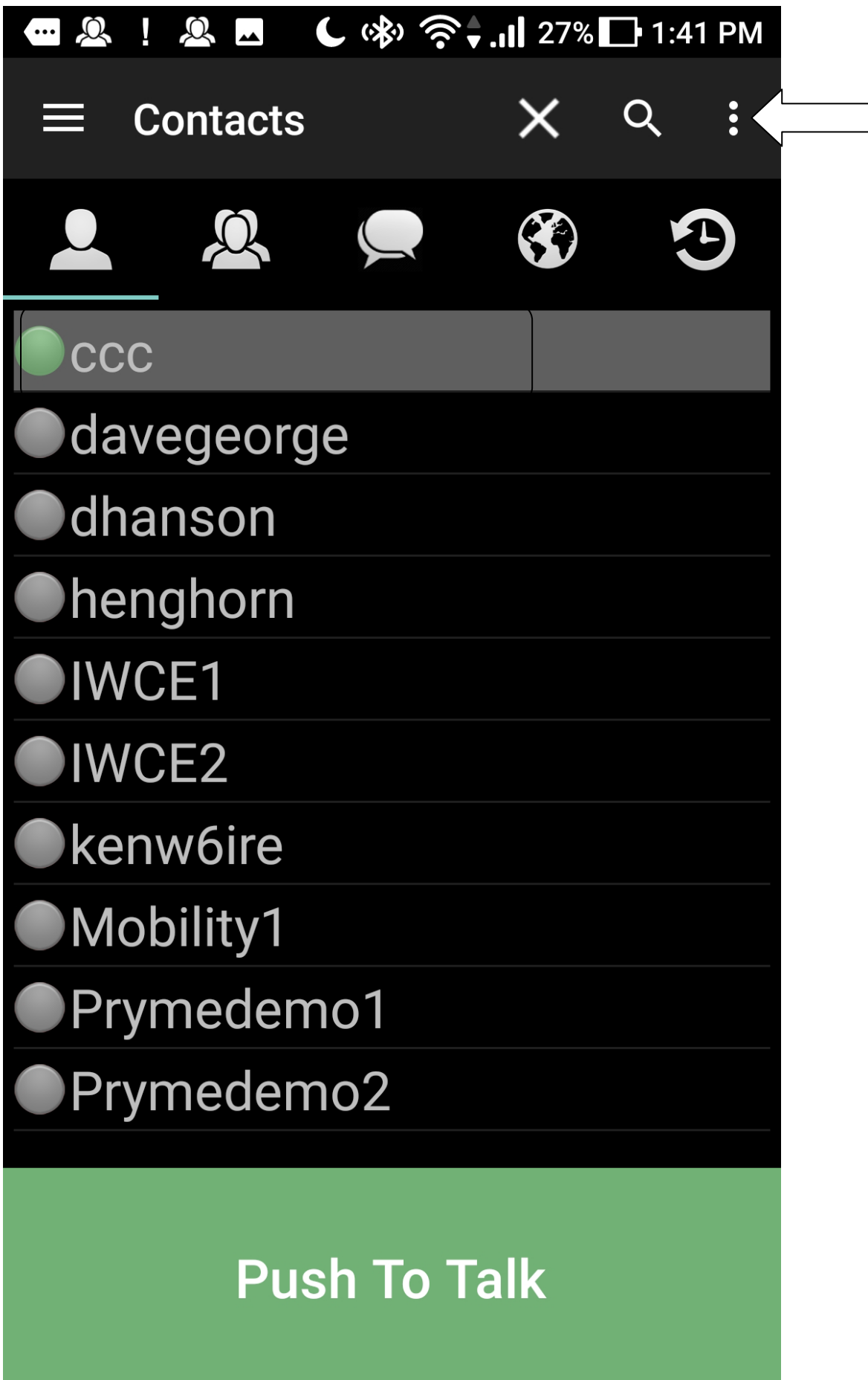

3. Select Setting .

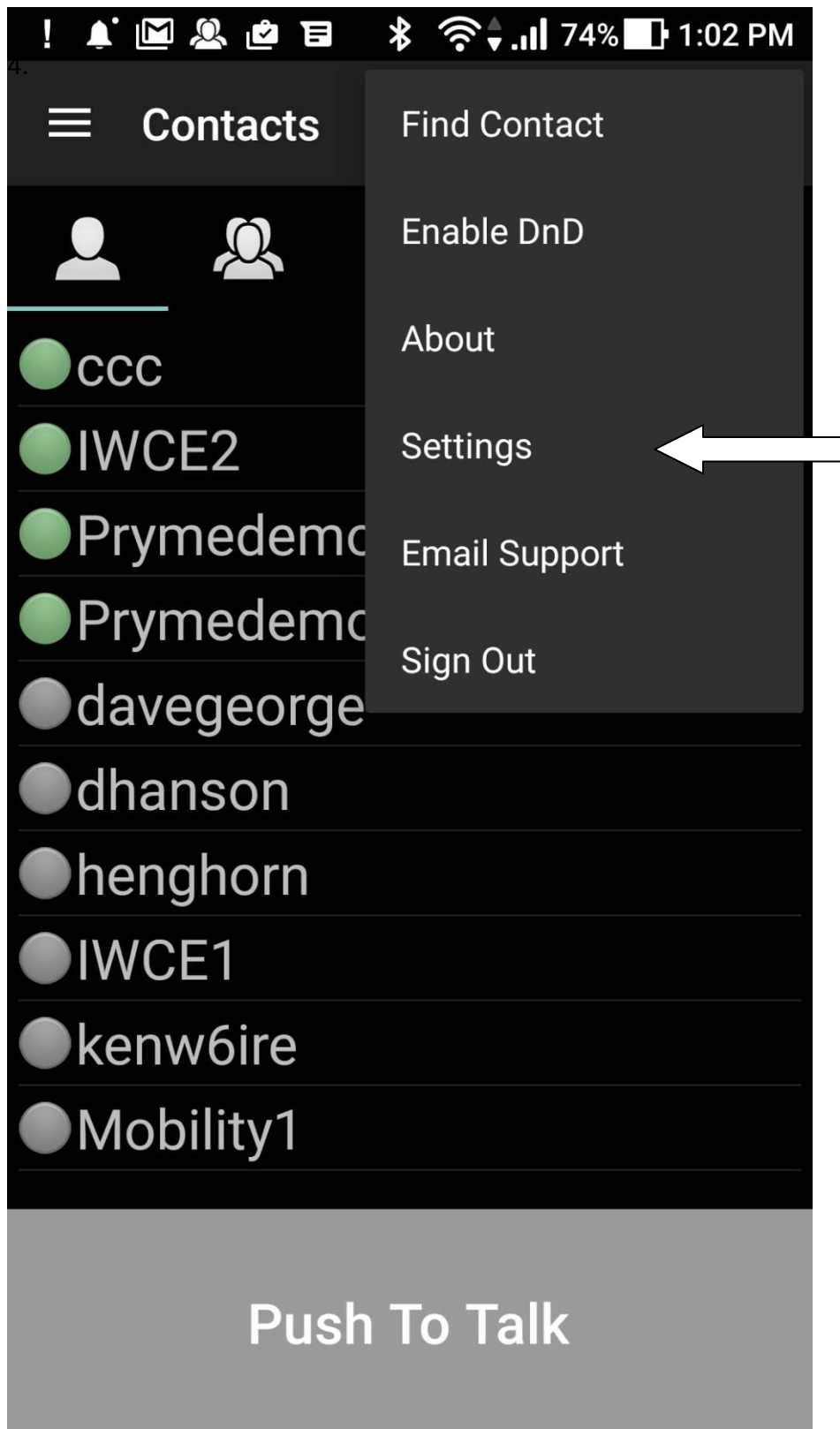

4. In Setting find Headset Type.

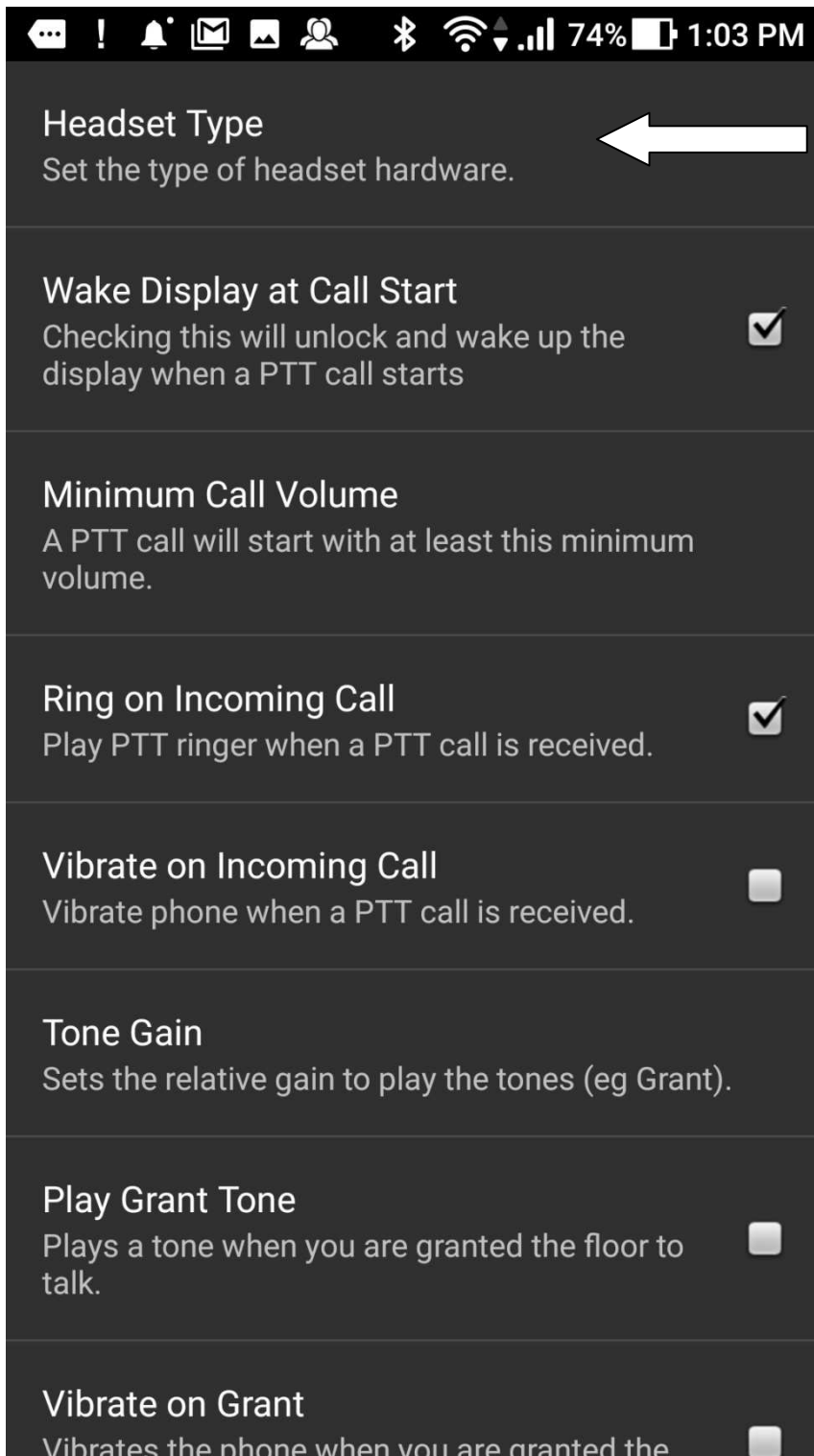

5. In Headset type Press “Bluetooth w/PTT” and back to main page, it’s ready to go.

